

# 900 SERIES

## PRESSURE GAGES

s-976C • s-976CKB • s-982C  
s-982CKB • s-986C • s-986CKB  
s-986CBNT • s-986CBNTKB

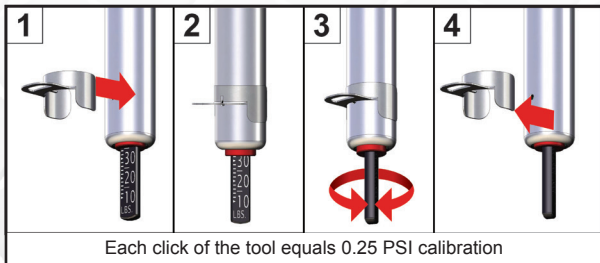

(ring not included)

Calibration tool hole

Brass tubular body

2-sided, black anodized aluminum indicator bar:

10-160 PSI  
or

80-1100 kPa / 0.8-11.0 Bar

Extended reach chuck

Hang hook

s-976C shown

### FIELD RE-CALIBRATABLE SERVICE GAGES

Exclusive Quick Click™ system provides dial-in accuracy

- Provide accurate, long life, trouble-free performance
- Nickel plated brass tubular body and 2-sided aluminum indicator bars
- 2 sides of indicator bar in PSI
- Calibrated in three ranges before leaving the factory
- Hang loop included
- s-986CBNT - 10° bend in neck for ease of access

PSI	s-976C	s-982C	s-986C	s-986CBNT
kPa/Bar	s-976CKB	s-982CKB	s-986CKB	s-986CBNTKB
Standard Dual Head	Large Bore Dual Head	Dual Head Straight Foot	Dual Head Straight Foot 10° Bend	

### EX516DIG

### EXELAIR™ HEAVY DUTY DIGITAL TIRE GAUGE

- 360° swivel dual head, straight foot chuck
- Pressure range: 5-100 PSI (measures PSI, kPa and Bar)
- Backlit digital display w/ auto shutoff
- Metal body for durability
- Slip resistant rubber grip
- Built in LED flashlight
- Batteries included

Retail Pkg Part No.	Per Card	Chuck Style	Product Specs		
			PSI	kPa	Bar
EX516DIG	1	Dual Head Straight Foot	5-100	1-7	35-800



AIR COUPLERS & PLUGS  
700/1700/1800 SERIES

DRIVEWAY SIGNALS  
800 SERIES

PRESSURE GAGES  
900 SERIES

F-R-Ls  
1000/1100 SERIES

TEST EQUIPMENT  
1200 SERIES

**PENCIL TYPE TIRE PRESSURE GAGES**

- USA made consumer tire gages
- Includes strong flexible white NYLON INDICATOR BAR to provide long, trouble-free life with the same certified accuracy associated with all Milton® tire gages
- Always check tire pressure when tires are cold

**911 • 914**



911



914

**PLASTIC PRESSURE GAGES**

- Body molded of rugged Delrin material

Bulk Part No.	Retail Part No.	Per Card	Pressure Range		Chuck Style	Feature/Applications
			PSI	Increments		
911BK	s-911	1	5 to 50	1 PSI	Single, Angled	Passenger Cars
914BK	s-914	1	20 to 120	2 PSI		Trucks, RVs, Bicycles

**917 • 920 • 921 • 923  
925 • 927 • 928 • 929**



917



920



921



923



925



927



928



929

**NICKEL PLATED BRASS PRESSURE GAGES**

Bulk Part No.	Retail Part No.	Per Card	Pressure Range		Chuck Style	Feature/Applications
			PSI	Increments		
917BK	s-917	1	2 to 20 (20 to 140)	1 PSI (10 kPa)	Single, Angled w/ Deflator Pin	Low Pressure ATVs, Golf Carts & Air Springs
920BK	s-920	1	10 to 70 (60 to 500)	2 PSI (20 kPa)		Higher Pressure Automobiles Built-in Tire Tread Depth Gage
921BK	s-921	1	5 to 50 (40 to 350)	1 PSI (10 kPa)	Straight	Passenger Cars
923BK	s-923	1	5 to 50 (40 to 350)			
925BK	s-925	1	2 to 120 (120 to 820)	2 PSI (20 kPa)	Single, Angled w/ Deflator Pin	Trucks, RVs & Bicycles
927BK	s-927	1	2 to 120 (120 to 820)		Dual Head	Trucks
928BK	s-928	1	5 to 50 (40 to 350)	1 PSI (10 kPa)	Single, Angled w/ Deflator Pin	Air/Water Filled Tractors
929BK	s-929	1	2 to 120 (120 to 820)	2 PSI (20 kPa)	Dual Head, Straight Foot	Trucks

**s-931 • s-932  
s-933 • s-934**

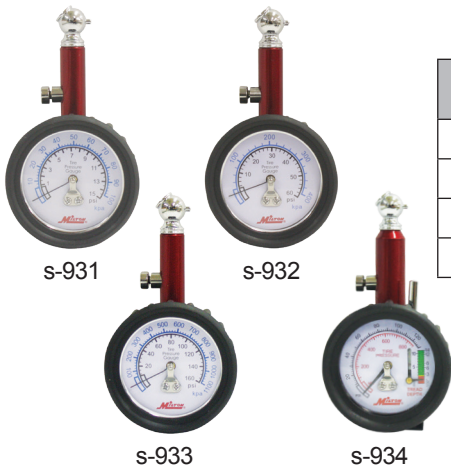

s-931

s-932

s-933

s-934

**DIAL TYPE TIRE GAGES**

- Internal diaphragm construction for greater durability
- 45° single chuck with deflator valve
- Durable rubber boot

Retail Part No.	Per Card	PSI		kPa		Tire Tread Depth Gage
		Range	Increments	Range	Increments	
s-931	1	0 to 15	1 PSI	0 to 100	2 kPa	No
s-932	1	0 to 60	2 PSI	0 to 400	20 kPa	
s-933	1	0 to 160	1 PSI	0 to 1100	20 kPa	
s-934	1	0 to 120	2 PSI	0 to 800	20 kPa	YES

AIR COUPLERS & PLUGS  
700/1700/1800 SERIES

DRIVEWAY SIGNALS  
800 SERIES

PRESSURE GAGES  
900 SERIES

F-R-Ls  
1000/1100 SERIES

TEST EQUIPMENT  
1200 SERIES

### s-935 • s-936



### EXTENDED REACH DIAL TYPE TIRE GAGES

Internal diaphragm construction for greater durability

- 12" length extended reach hose
- Dual head chuck w/ deflator valve
- Durable rubber boot

Retail Part No.	Per Card	PSI		kPa		Tire Tread Depth Gage
		Range	Increments	Range	Increments	
s-935	1	0 to 60	2 PSI	0 to 400	20 kPa	No
s-936	1	0 to 160	5 PSI	0 to 1100	20 kPa	

### 951 • 956



### HEAVY DUTY EXTENDED REACH DIAL TYPE TIRE GAGES

9" extension with straight large bore chuck comes with cushioned grip

- Internal diaphragm construction for greater durability
- Durable rubber boot

Retail Part No.	Per Card	Chuck Type	Hose Length	Overall Extended Length	PSI		kPa	
					Range	Increments	Range	Increments
951	1	12" Dual Head, Straight Foot	10.5"	22.5"	0 to 160	5 PSI	0 to 1100	20 kPa
956	1	9" Straight Large Bore		14"				

### s-976 • s-982 • s-986



### SERVICE GAGES

Provide accurate, long life, trouble-free performance

- Nickel plated brass tubular body and 4-sided nylon indicator bars
- 2 sides of indicator bar in PSI, 2 sides in kPa
- 10-160 PSI (2 lb increments) / 80-1100 kPa (20 kPa increments)
- Calibrated in three ranges before leaving factory
- Hang loop included
- 986BNT - 10° bend in neck for ease of access for dualies

Bulk Part No.	Retail Part No.	Per Card	Chuck Style	Overall Length
	s-976	1	Standard Dual Head	12-3/4"
	s-982	1	Large Bore Dual Head	13 1/4"
	s-986	1	Dual Head Straight Foot	13"
986BNT	s-986BNT	1		

### s-99900



### DIGITAL READ TIRE PRESSURE GAGE

Automatic shut off - highly accurate

- Consistent repeatability
- Durable construction

Retail Part No.	Per Card	Pressure Range			CR2032 Battery
		PSI	kPa	Bar	
s-99900	1	2 to 99	15 to 700	0.15 to 7.0	Included